

GRV30

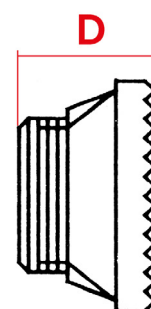
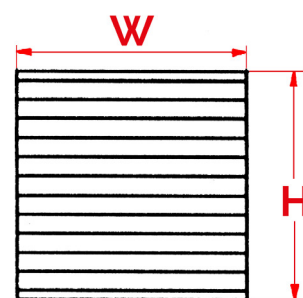
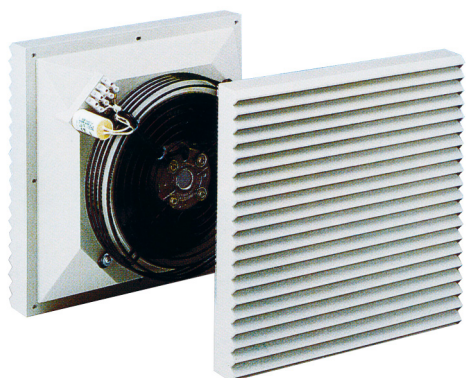

CODICE - CODE - ARTIKELNUMMER - CODIGO	M.U.	GRF30	GRV300A(P)220	GRV300A(P)222
Portata Aria GRV - GRV Fan Flow - Luftmenge GRV - Caudal aire ventil GRV	m ³ /h	--	500	500
Portata Aria GRV+GRF - Fan Flow GRV+GRF - Luftmenge GRV+GRF - Caudal aire ventil GRV+GRF	m ³ /h	--	345 1xGRF30 390 2xGRF25 450 2xGRF30	345 1xGRF30 390 2xGRF25 450 2xGRF30
Alimentazione - Power Supply - Spannungsversorgung - Tensión	V-ph-Hz	--	230-1-50/60	115-1-50/60
Altezza / Larghezza / Profondità - Height / Width / Depth Höhe / Breite / Tiefe - Altura / Ancho / Profundidad (HxWxD)	mm	323x323x40	323x323x160	323x323x160
Potenza Assorbita/Corrente Assorbita - Absorbed Power/Absorbed Current Leistungsaufnahme/Stromaufnahme - Potencia Absorbida/Corriente Absorbida	W/A	--	70 / 0,38	75 / 0,6
Fusibile T - Pre-Fuse T - Absicherung T - Elemento Previo de Fusibile T	A	--	0,5	1
Limiti di Temperatura - Temperature Limits - Temperaturbereich - Limites Temperatura	°C	--	-10 / +75	-10 / +70
Protezione lato armadio - Side cabinet protection degree Schutzgrad Schrankseite - Protección lado armario	IP	44	44	44
Rumorosità - Noise level - Geräuschpegel - Nivel de ruido	dB(A)	--	69	69